

## Get students comfortable and confident for the Georgia Milestones Assessment System

Each BrainPOP lesson—whether it's in social studies, science, math, ELA, or the arts—includes movies and activities that give students practice in the knowledge and skills they'll need to feel confident on test day.



### Georgia Milestones expectation for students

**Answer Technology-Enhanced Item (TEI) question types**—which students often find more challenging.

**TEIs require that students think critically and deeply**—and use problem-solving skills—to answer questions.

Demonstrate a wide breadth of **content knowledge and comprehension and technological skills** in a limited amount of time.

### Students' experience on BrainPOP (for grades 3-8)

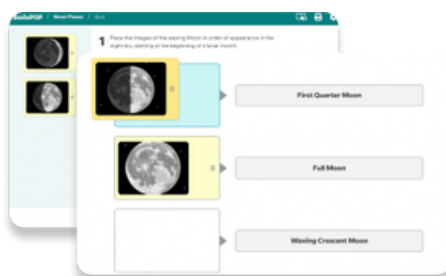

**Auto-graded learning activities and embedded assessments mirror TEIs in format and rigor**, letting students practice their technological skills, demonstrate their understanding, and build testing confidence all year long.

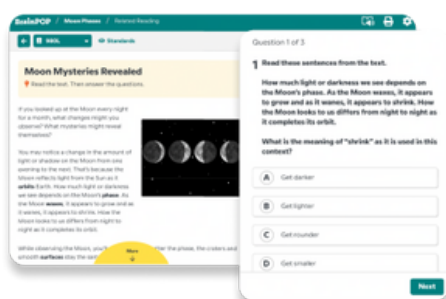

From evaluating sources to extracting key details and interpreting unfamiliar words, **students develop, practice, and apply skills** alongside everything they learn.

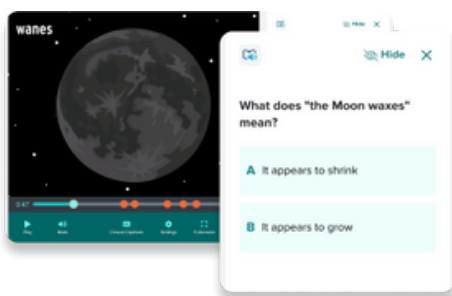

BrainPOP's cross-curricular approach combines **content instruction and skill practice into one time-saving lesson** to make the most of every instructional minute.

# Prepare and empower middle school students for the Georgia Milestones Assessment System - Science

BrainPOP Science's investigations and engineering projects provide standards-aligned ways to nurture middle schoolers' innate scientific curiosity—while simultaneously preparing them for their assessments.



## Georgia Milestones Science Multidimensional Expectation

Students are expected to know more than the standards and scientific principles. They need to be able to “practice the practices.”

Students will need to **build explanations, use evidence to craft arguments, and obtain, evaluate, and communicate information.**

Students will navigate **technology-enhanced question types (TEIs)**, which are constructed to engage students' critical thinking and problem-solving skills.

## Students' Experience on BrainPOP Science

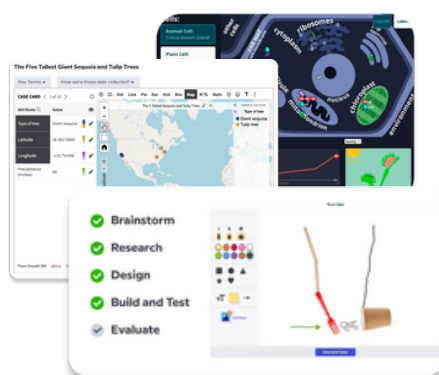

✓ **Standards-aligned investigations and real-world engineering projects** are designed to integrate science practices—like computational thinking and the design process—with scientific concepts.

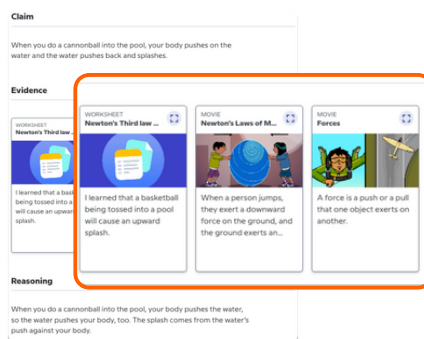

✓ **The CER writing process is embedded into BrainPOP Science:** it guides students through collecting observations, deciding which become evidence, and writing (and supporting) an evidence-based claim.



✓ Technology-enhanced question types and multidimensional science content are **built into BrainPOP Science's formative assessments**—giving students consistent practice in both all year long.



Meet the needs of the Georgia Standards of Excellence (GSE) for Science

**Did you know** that BrainPOP Science's approach is proven to improve students' evidence-based writing by **up to 20%**?

Learn more at [brainpop.com/classroom\\_solutions/research](https://brainpop.com/classroom_solutions/research)

# Raise the bar for multidimensional science in Georgia

BrainPOP Science's inquiry-driven investigations with real-world engineering projects align with the 5E instructional model and **Science Georgia Standards of Excellence (GSE)** to empower middle schoolers to discover the science in everything.



Strengthen science practices with real-world phenomena while boosting writing and critical-thinking skills



Prepare for end-of-year online testing with integrated SEPs and assessments



Expand teacher capacity with built-in teacher guides and clickable rubrics

## Prepare Georgia middle schoolers for high school science

**Over 100 immersive investigations** center around relatable guiding questions and phenomena to nurture innate scientific curiosity as students interact with 3D Worlds™, Simulations, and Data Manipulatives.

- Middle school students are prepared for science testing by engaging with the principles of the Engineering Design Process (EDP). Teachers are equipped with actionable data to refine instruction with practice opportunities reflective of the Georgia Milestones Assessment System questions.
- Embedded formative assessment and immersive tools not only build confidence in your 5th and 8th graders for the end-of-year assessments, but also give real-life opportunities to hone critical-thinking skills as they discover the science in everything.
- Our ready-to-use investigations aligned with Georgia's GSE cultivate middle schoolers' innate curiosity, while integrating the EDP practices of identifying problems, creating prototypes, and iterating solutions.



**New this year**

## Enhanced reports with new teacher insights

See how teachers and students are using BrainPOP Science in real-time to support instructional decisions.

